



MASTER SWITCH

Part # 24182-46

INSTALLER: Leave these instructions with consumer.
CONSUMER: Retain for future reference.



This master switch is for replacement in an Echelon Diamond Grill. To install, follow the steps below:

1. Ensure the grill is completely cool, the knobs are in the off position, the gas supply to your grill is turned off, the master switch is off, and the power supply is disconnected.
2. Pull off the control knobs. Slowly lift away the lighted bezels to clear the valve stems, and carefully disconnect the wires found on the back of the bezels (use your fingernail).
3. Remove the smoker drawer and drip tray.
4. Unscrew and remove the control panel screws and washers. Lift the control panel up and outward, allowing it to rest on the internal chain(s).
5. Locate the master switch on the right side of the exposed control panel, and disconnect the wire harness (see Fig. 1-1).
6. From the inside of the control panel, use pliers or an open ended wrench to loosen the nut that is securing the master switch in place. Use your hand to completely remove the nut. See Fig. 1-2.
7. Remove the master switch.
8. Your grill may have a knockout around the now exposed master switch opening. If so, use your fingers or a tool to completely remove the knockout (see Fig. 1-3). If not, proceed to the following step.

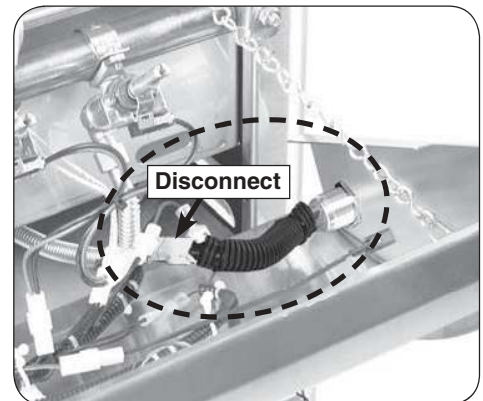

Fig. 1-1 Master switch location

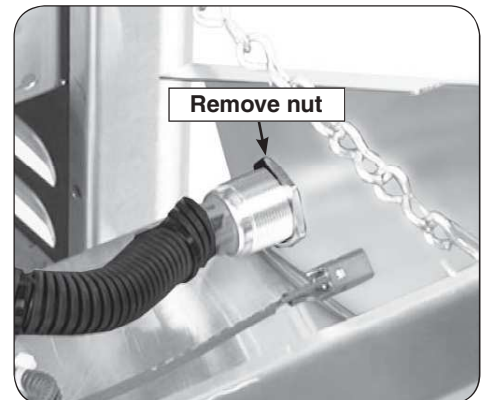

Fig. 1-2 Remove master switch nut



Fig. 1-3 Remove knockout ring (if applicable)

ROBERT H. PETERSON CO. • 14724 East Proctor Avenue • City of Industry, CA 91746

9. Ensuring the O-ring is flat against the master switch; insert the new master switch into the opening. Use the nut provided with your new master switch to hand tighten the switch in place. Use pliers or an open end wrench to secure. Reference Fig. 2-1.
10. Connect the wire harness (see Fig. 2-2).
11. Connect the power supply, & test your new master switch prior to replacing the control panel.
12. Set the control panel back over the front lip of the grill, being sure that the lid-closed-sensor protrudes through the hole on the upper right of the control panel (if applicable). Replace the screws.
13. Replace the smoker drawer, drip tray, lighted bezels, and control knobs.
14. With the knobs in the **OFF** position, turn on the gas supply.



Fig. 2-1 Installing master switch

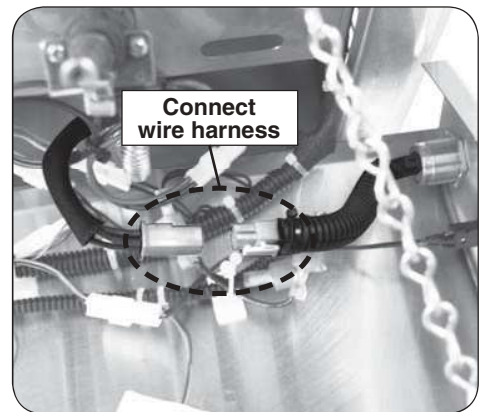

Fig. 2-2 Connect wire harness